

Evolution

NO-SMOKE



*The new
Generation*

E VOLUTION: the Evolution no-smoke self-supporting suction arm represents the best technical solution for the suction of welding smoke, gas, vapours, aerosol, oil fumes, dusts, etc.

COMPLIANCE WITH THE LAW:
l'Evolution no-smoke has been designed and built in full compliance with current laws relating to the safety of the place of work and the removal of hazardous fumes and polluting substances from the working environment.



Evolution ø150 mm trailer mounted version

Evolution
NO SMOKE



Evolution ø150mm wall mounted version with "Bandiera 2000"



Evolution in aluminum $\phi 180\text{mm}$ and $\phi 200\text{mm}$ wall mounted version

OPERATING PRINCIPLE: the polluted air is sucked in through the jointed hood and passes through pipes made of sturdy sheet metal (zinc-plated, inox, scratchproof enameled, aluminum) to the high-efficiency fan or to the system's central piping system, and from here to the filtering unit used in the specific applications. The pipes and the hood of the Evolution no-smoke are coupled together by special external articulated joints that we have patented, and a high resistance flexible pipe NO-SMOKE FLEX which allow easy and convenient movement of the arm. The Evolution no-smoke arm is also equipped with a rotary bearing which enables rotation through even 360° if installed on its special stand. The flow of polluted air that passes through the suction duct created in the arm, is not therefore, hindered by internal joints or articulations. Due to the reduced length of the hose used in the elbows, load losses are far lower than with other similar systems on the market. Less load loss means: lower fan power, hence energy saving; lower air flow speed, hence less noise.



Evolution $\phi 150\text{ mm}$, 3 mt. enamelled painted

Evolution
NO-SMOKE



- Evolution $\phi 150\text{mm}$ - 4,0 mt.
enamelled painted with fan

- Central suction system with EVOLUTION NO-SMOKE arms

1

- Evolution No-Smoke arms connected to pipeline

2

- AIRALT cartridge filter

3

- Suction fan with soundproofing box

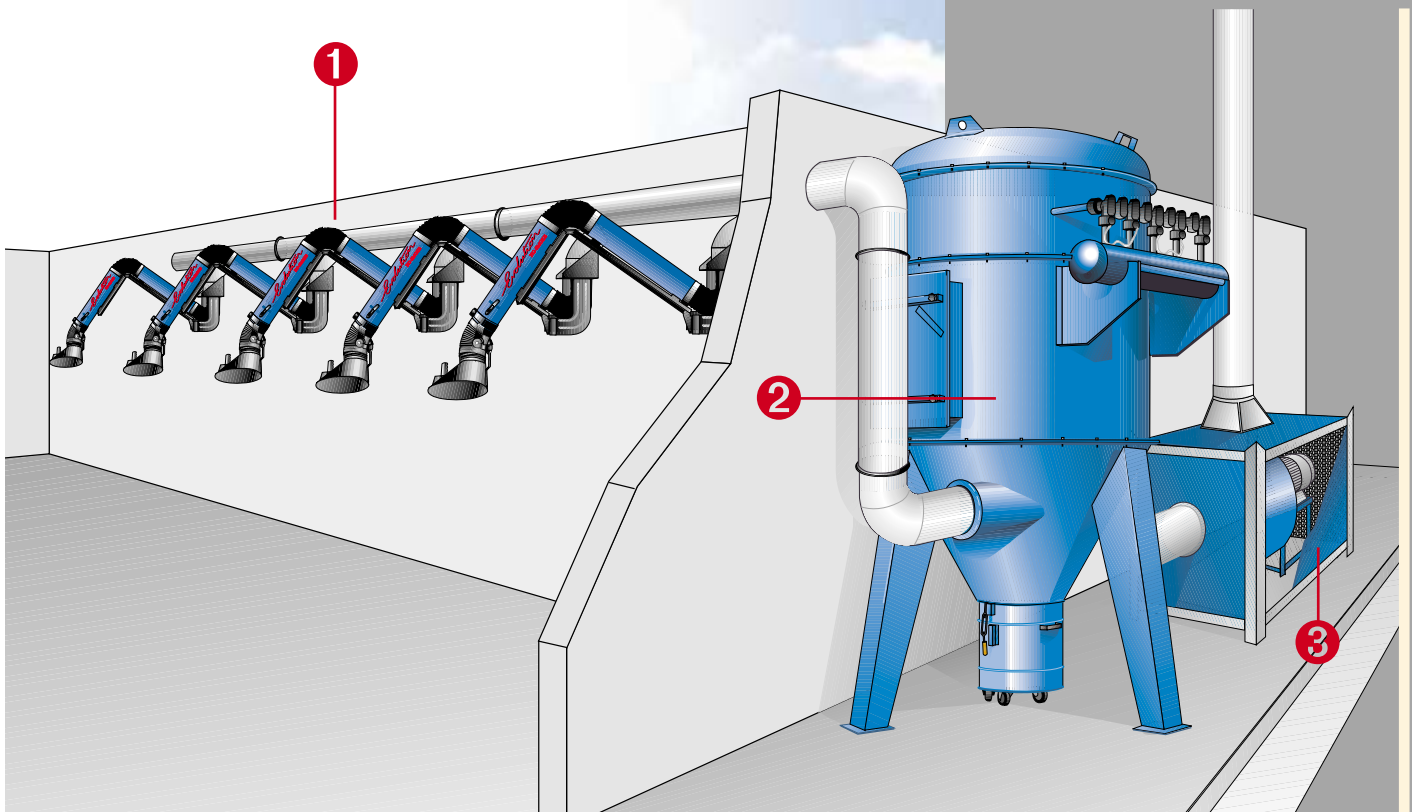

ENERGY SAVING: the extraction of hazardous fumes from the working environ-

ment during the Winter months, lowers heavily their temperature. The Evolution No-Smoke suction arm represents the ideal solution to this drawback as, thanks to the built-in adjustment shutter, it is possible to meter the amount of air to be taken in. It's also possible to filter the polluted air using special optional filters supplied as accessories and recycle it back to the environment completely free of pollutants.



- Evolution No-Smoke ø100
mm -2,1 mt enamelled painted

EVOLUTION

No-Smoke

TECHNICAL FEATURES

WALL MOUNTED VERSION

1
Closed arm

2
Open arm

3
Workposition

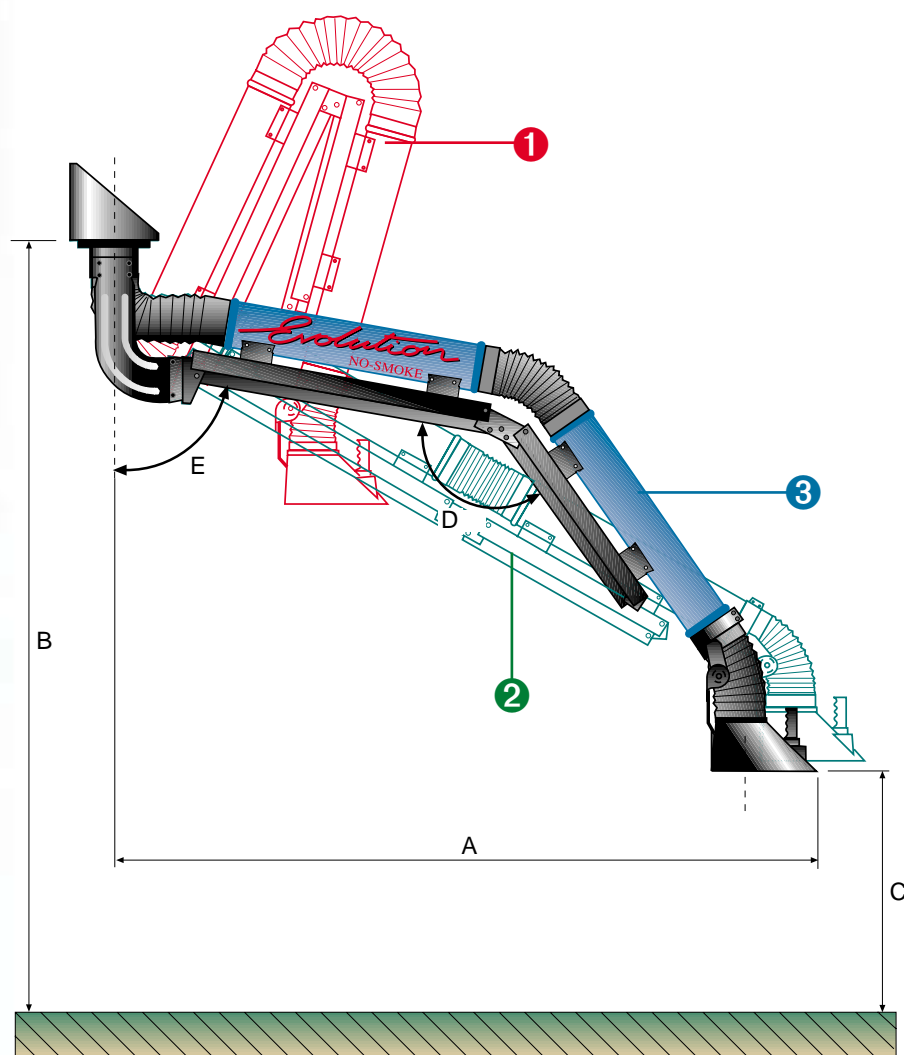

TECNICAL FEATURES

	mm. mt.	ø100 2,7	ø125 3,0	ø125 4,0	ø150 3,0	ø150 4,0	ø180 3,0	ø180 4,0	ø200 3,0	ø200 4,0
Workposition	A	2200	2400	3300	2450	3300	2050	3115	2365	3200
	B	3000	3000	3000	3000	3000	3000	3000	3000	3000
	C	1500	2200	1300	1400	2000	1700	1300	1200	1400
	D	110°	110°	120°	145°	110°	90°	115°	140°	115°
	E	100°	130°	100°	80°	120°	120°	105°	80°	105°
Open arm	A	2200	2600	3600	2800	3600	2600	3720	2600	3730
	B	3000	3000	3000	3000	3000	3000	3000	3000	3000
	C	1200	2200	2000	2300	1500	2250	2250	2200	2230
	D	145°	180°	180°	180°	150°	180°	180°	180°	180°
	E	78°	90°	90°	90°	90°	90°	90°	90°	90°
Closed arm	A	600	780	962	900	1000	580	800	800	1000
	B	3000	3000	3000	3000	3000	3000	3000	3000	3000
	C	2100	2000	2200	2100	2100	1900	2050	1970	2000
	D	10°	5°	10°	10°	10°	0°	5°	10°	10°
	E	155°	165°	150°	150°	150°	150°	160°	150°	155°

- All data are indicated in mm.

COVERED AREAS

With wall-mounting

With column-mounting

With ceiling-mounting

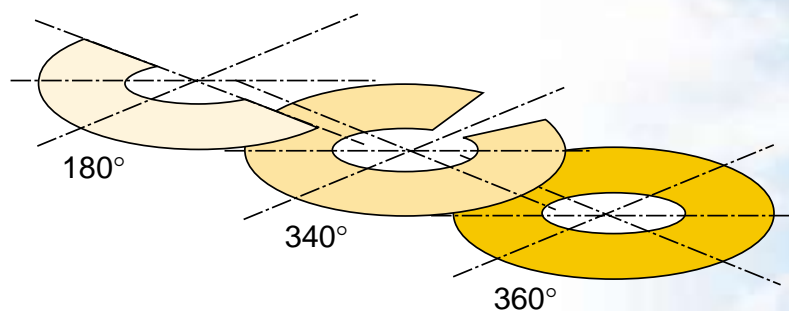

TRAILER MOUNTED VERSION

1

Closed arm

2

Open arm

3

Workposition

* According to use

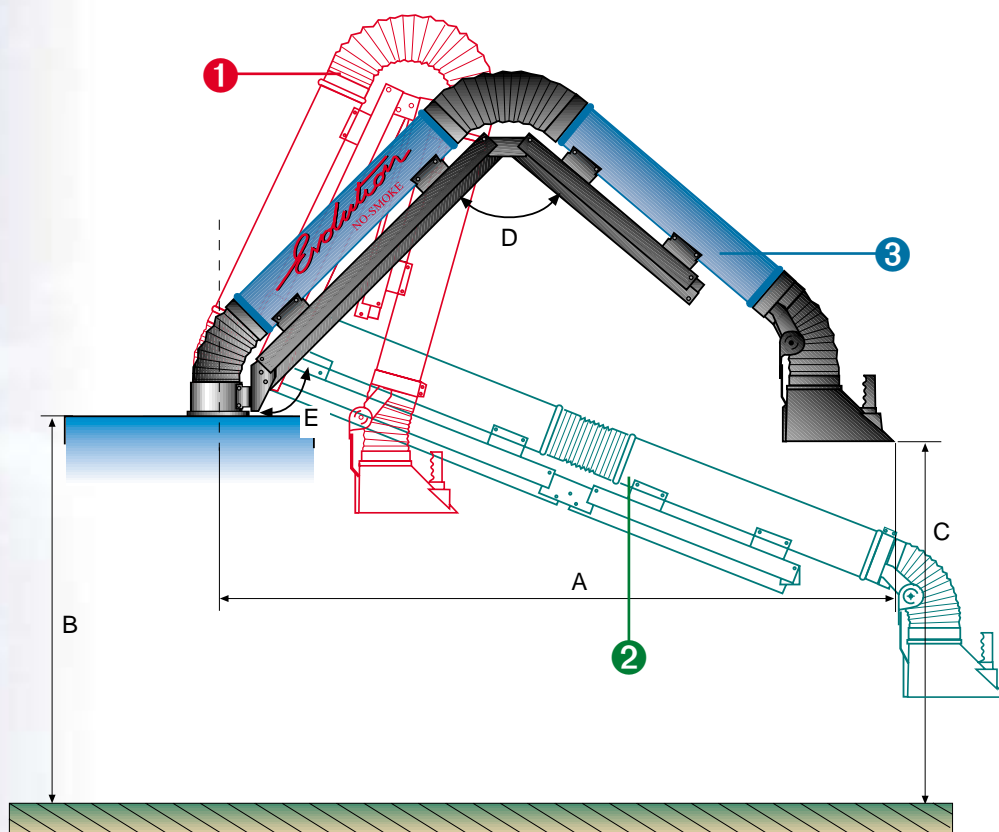

mm	ø100	ø100	ø125	ø125	ø150	ø150	ø180	ø180	ø200	ø200
mt	2,1	2,7	3,0	4,0	3,0	4,0	3,0	4,0	3,0	4,0

Workposition	A	1420	2000	2200	3300	2300	2000	2175	1550	1700	2000
	B	*	*	*	*	*	*	*	*	*	*
	C	*	*	*	*	*	*	*	*	*	*
	D	110°	110°	110°	110°	110°	55°	110°	130°	75°	55°
	E	140°	125°	125°	125°	125°	145°	125°	100°	125°	145°
Open arm	A	1640	2300	2500	3700	2600	3800	2490	3600	2470	3620
	B	*	*	*	*	*	*	*	*	*	*
	C	*	*	*	*	*	*	*	*	*	*
	D	180°	180°	180°	180°	180°	180°	180°	180°	180°	180°
	E	90°	90°	90°	90°	90°	90°	90°	90°	90°	90°
Closed arm	A	400	370	580	604	640	600	526	550	710	600
	B	*	*	*	*	*	*	*	*	*	*
	C	*	*	*	*	*	*	*	*	*	*
	D	0°	0°	0°	0°	0°	0°	0°	0°	0°	0°
	E	180°	180°	180°	180°	180°	180°	180°	180°	180°	180°

- All data are indicated in mm.

LOAD LOSSES

Extended Evolution No-Smoke Arm load losses

Ø 100 L=2,7 mt.

Ø 100 L=2,1 mt.

Ø 125 L=4 mt.

Ø 125 L=3 mt.

Ø 150 L=4 mt.

Ø 150 L=3 mt.

Ø 180 L=4 mt.

Ø 180 L=3 mt.

Ø 200 L=4 mt.

Ø 200 L=3 mt.

mm H₂O

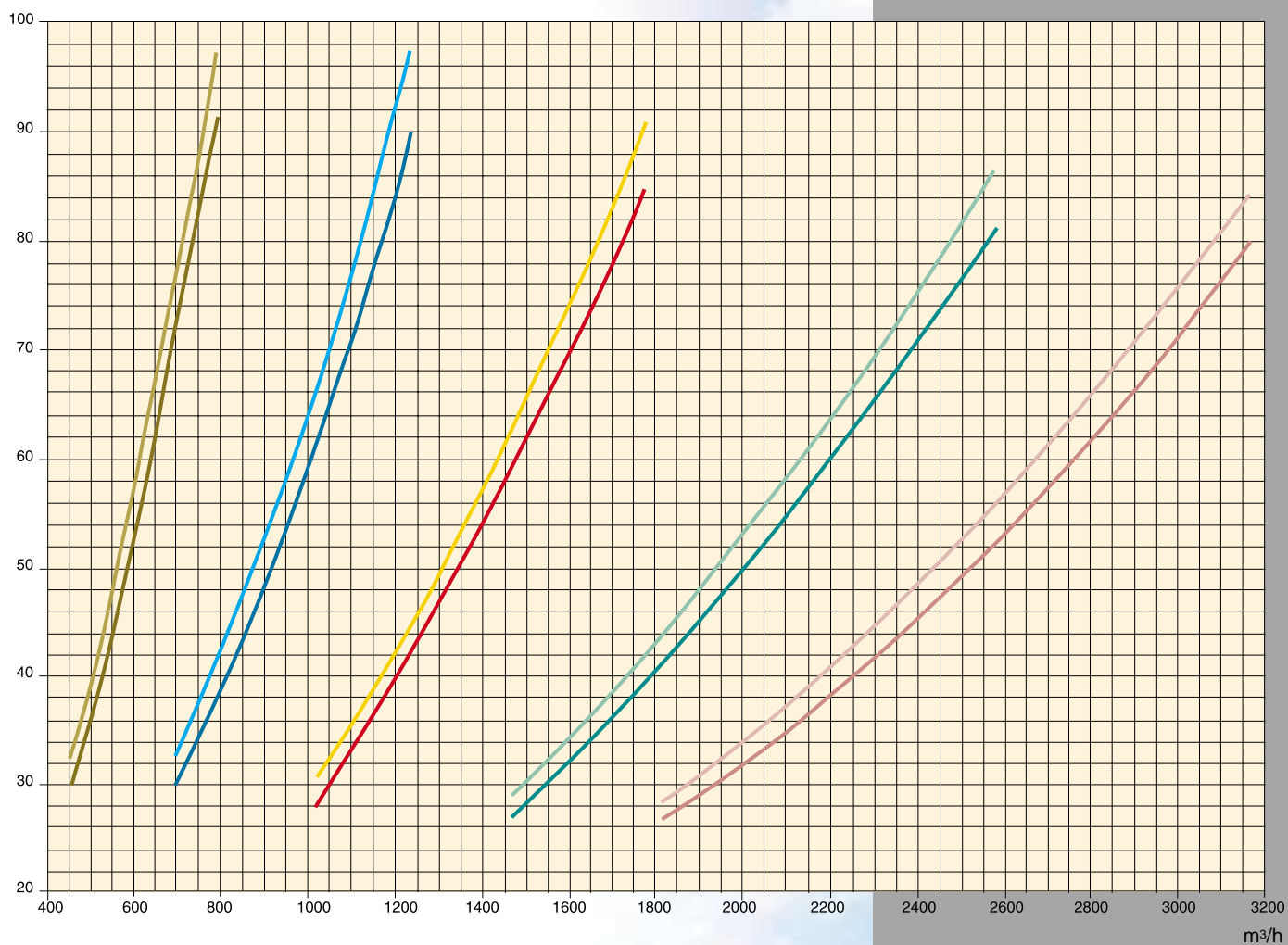

Fans

TECHNICAL FEATURES

	A	B	C	D	ØE	ØF	H	I	L	M	N	O	P	Q	R	S	T	dB(A)
HP 0,5/Ø100	140	185	200	245	105	150	392	242	351	409	182	114	170	170	52	215	183	73
HP 0,75/Ø125 - Ø150	140	185	200	245	162	216	392	242	351	409	182	114	170	170	52	215	183	75
HP 1/Ø150	160	160	220	220	152	216	432	287	429	477	212	162	190	198	53	190	204	80
HP 2/Ø150	180	180	240	240	153	216	502	378	535	619	257	227	210	278	48	210	223	82
HP 2/Ø180 - Ø200	200	200	260	260	205	268	522	412	601	685	286	258	230	320	47	230	243	82
HP 3/Ø150	180	180	240	240	153	216	502	378	535	619	257	227	210	278	48	210	223	84
HP 3/Ø180 - Ø200	200	200	260	260	205	268	522	412	601	685	286	258	230	320	47	230	243	84

EVOLUTION	Ø100mm 2,1 mt	Ø100mm 2,7 mt	Ø125mm 3,0 mt	Ø125mm 4,0 mt	Ø150mm 3,0 mt	Ø150mm 4,0 mt	Ø180mm 3,0 mt	Ø180mm 4,0 mt	Ø200mm 3,0 mt	Ø200mm 4,0 mt
HP 0,50	604	590								
HP 0,75			1100	1050						
HP 1			1250	1150	1700	1630				
HP 2					1900	1850	2000	1900	2500	2450
HP 3							2300	2050	3000	2850
Max delivery - [m³/h]										

- Alla data are indicated in mm.

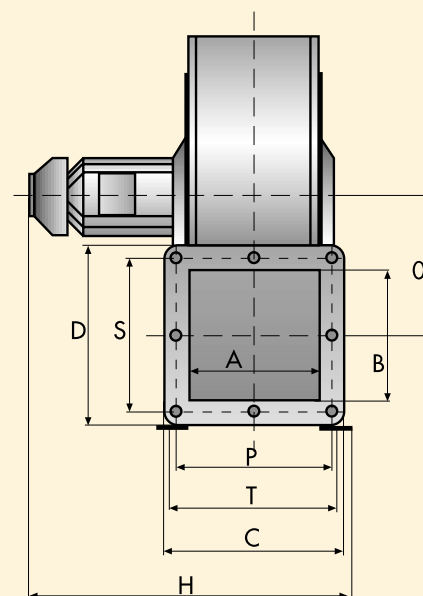
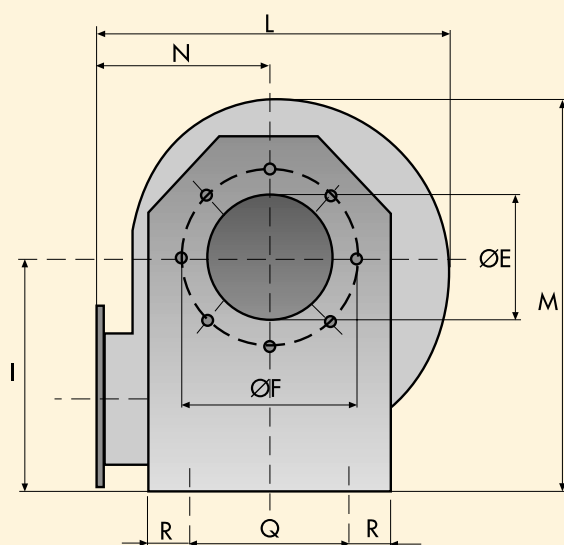

• NO-SMOKE Fan

TELESCOPICO

Evolution No-Smoke

Evolution
NO-SMOKE



TELESCOPICO NO-SMOKE Ø150mm

Workposition	A	1850	Open arm	A	2000	Closed arm	A	1600
	B	2500		B	2500		B	2500

- Alla data are indicated in mm

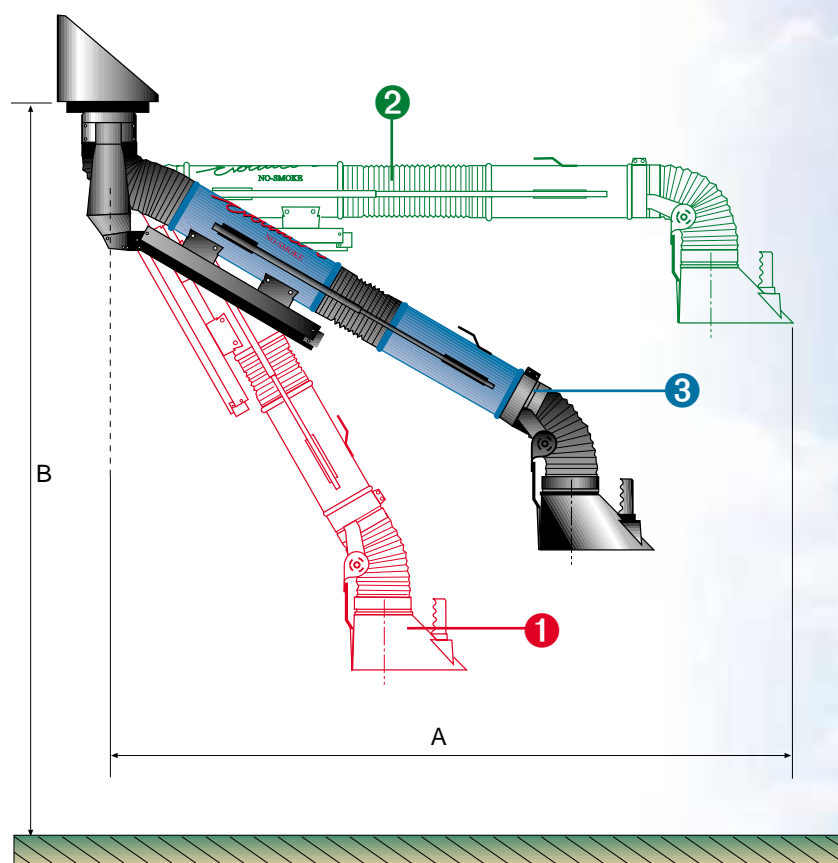

1
Closed arm

2
Open arm

3
Workposition

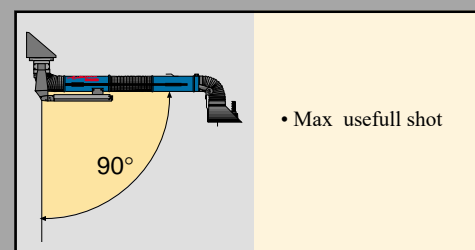

FLEX

Evolution No-Smoke



THE FLEX EVOLUTION NO-SMOKE can be hung on the wall (FLEX EVOLUTION NO-SMOKE/M) or be positioned on the working table (FLEX EVOLUTION NO-SMOKE/T).

Its main application is in the chemical or electronic industry.



- Flex Evolution No-Smoke/T applied in the worktop

TECHNICAL FEATURES

FLEX EVOLUTION NO-SMOKE

Max length	ø 100	1580	Min length	ø 100	460
	ø 125	1610		ø 125	490
	ø 150	1650		ø 150	530

- Alla data are indicated in mm.

FLEX EVOLUTION NO-SMOKE/T

Table Mounted Flex Evolution No-Smoke

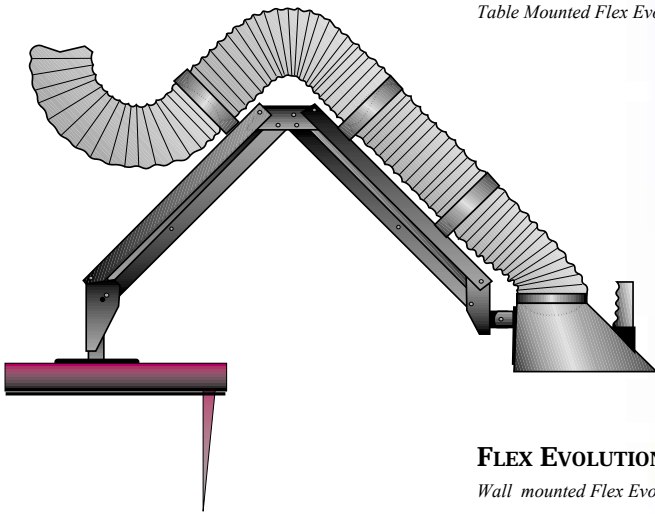

FLEX EVOLUTION NO-SMOKE/M

Wall mounted Flex Evolution No-Smoke

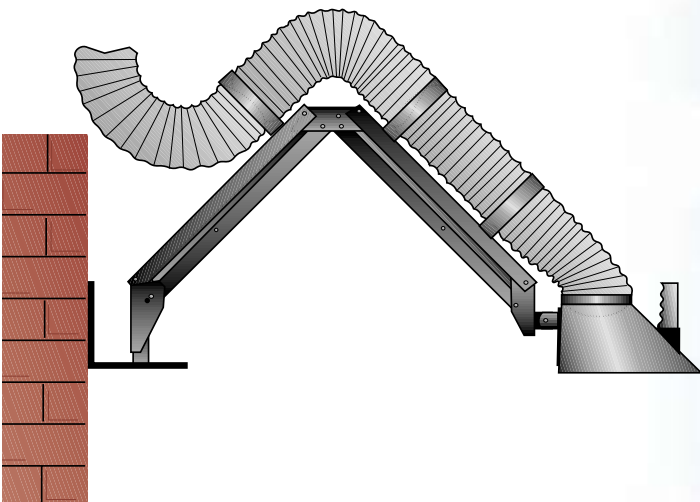

Flex ø100

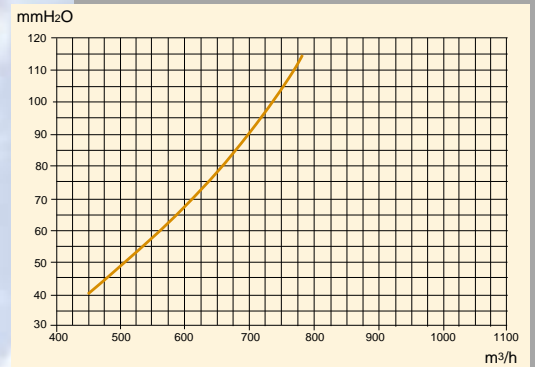

Flex ø125

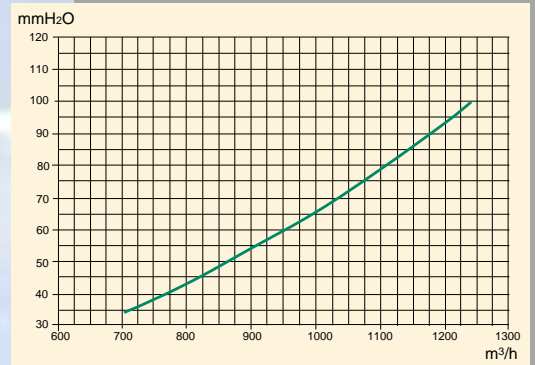

Flex ø150

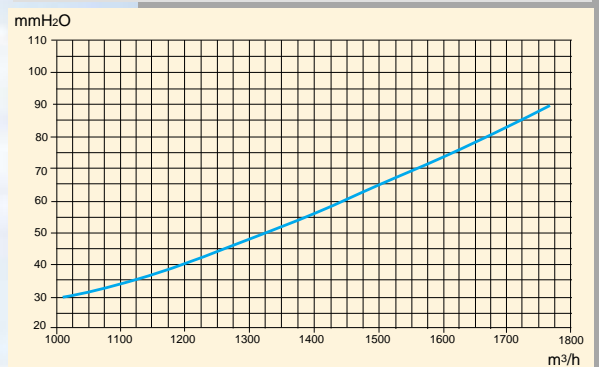

YOUR HEALTH IS IMPORTANT TO US !

A good suction is the most effective solution to avoid the welding fumes polluting substances, etc. , to reach our organism.

***EVOLUTION No-SMOKE
IS THE SOLUTION.***

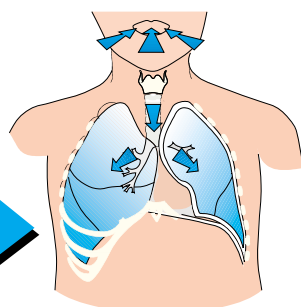
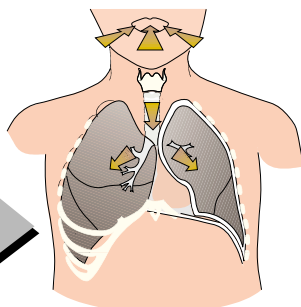
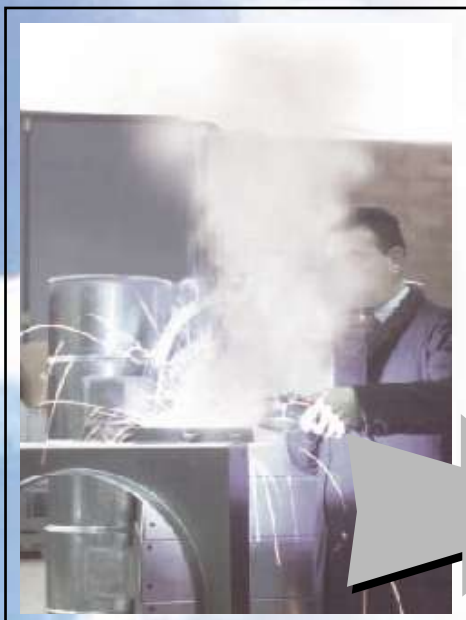

N

NEW EXTERNAL PATEND ARTICULATED JOINT

The key point and main feature of the arm, is the new external articulated joint that allows to not obstruct the air flow and the passage of the polluting substances; infact, the particular study of the Evolution No-Smoke design has permitted us to reach a very high competitive functional quality.

RESULT: A PERFECT PRODUCT.

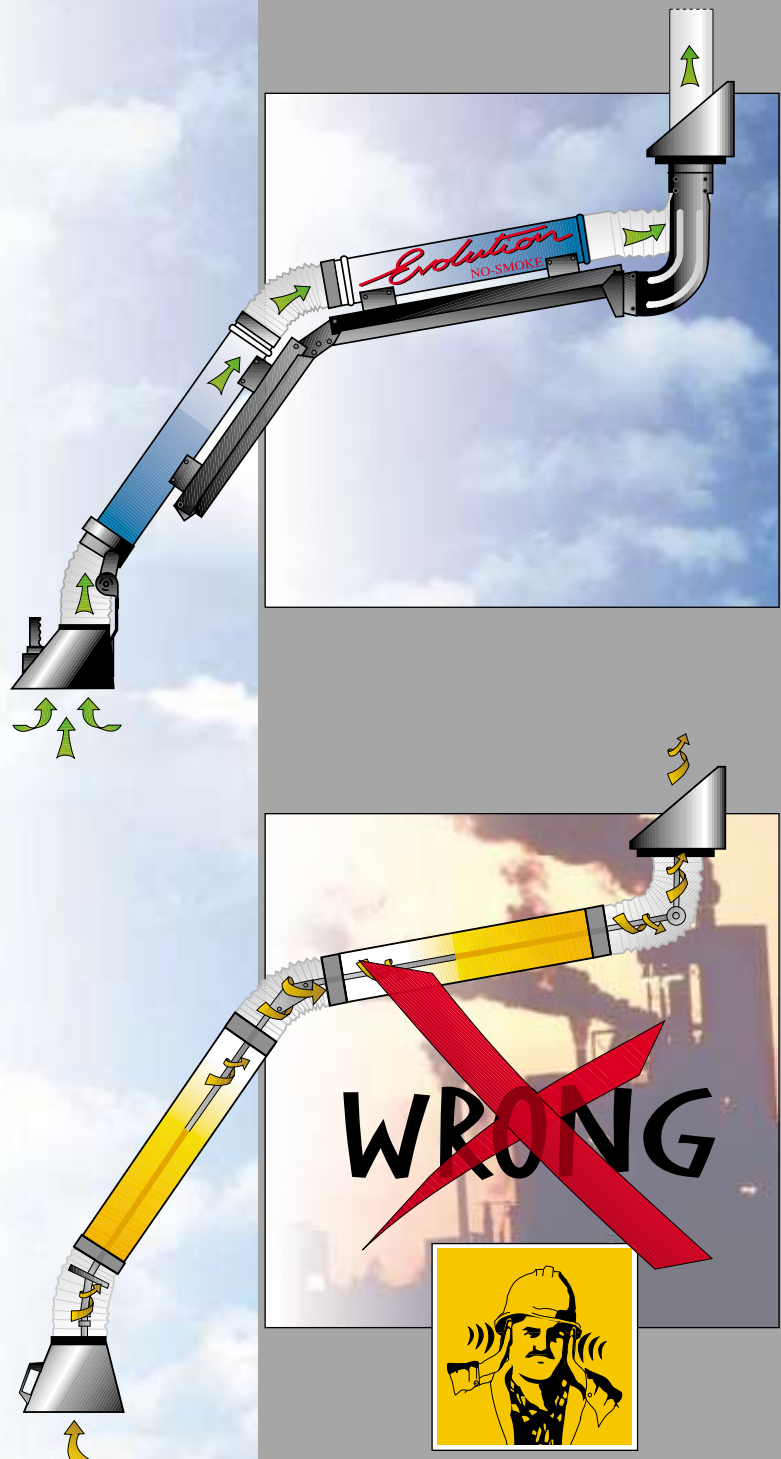

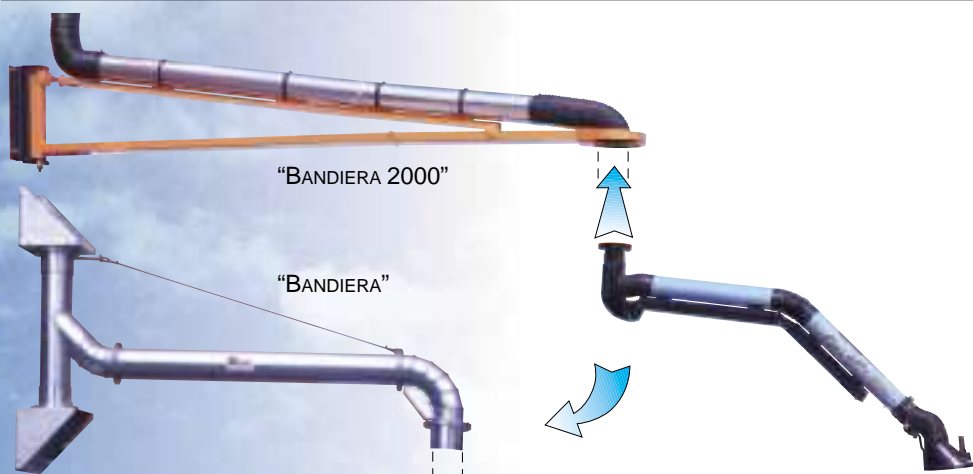

Evolution No-Smoke whit "BANDIERA"* and "BANDIERA 2000"*: possibility to reach the length of 8,5 mts.

- A** • Evolution No-Smoke with "BANDIERA 2000"
- C** • Arm Evolution No-Smoke wall mounted version with fan

- B** • Telescopic Evolution No-Smoke arm wall mounted version

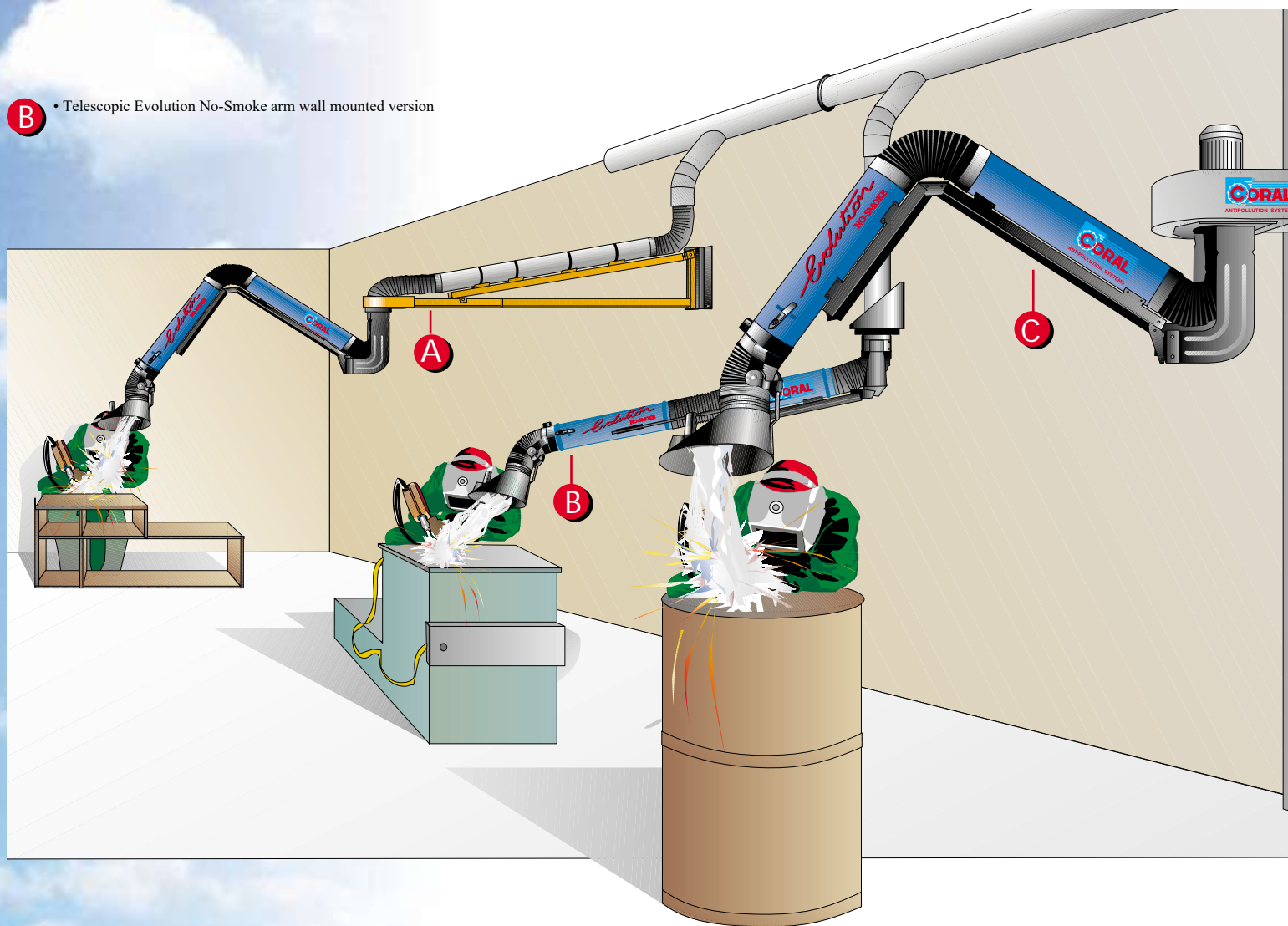

* OPTIONALS

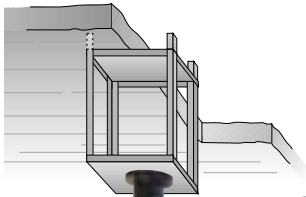

- Evolution No-Smoke with roof mounting support*



- Evolution No-Smoke with Blindair*

- Telescopico Evolution No-Smoke with wall support*



- Evolution No-Smoke with fan*

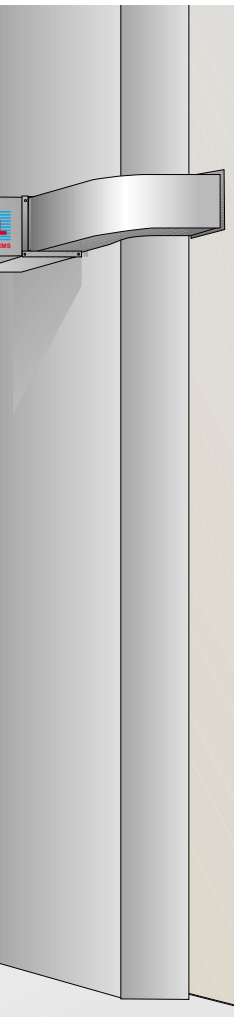

- Evolution No-Smoke with column support* for 1-2 arms



- Evolution No-Smoke trailer mounted version

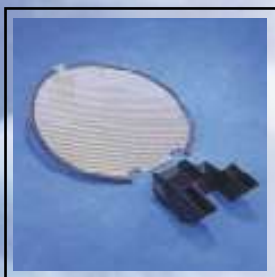

- Sparks stop net kit for plastic hood Ø 150 mm complete with: net, protection carter.



- Light kit for plastic hood Ø 150 mm complete with: lampe halogene 24V. 20W., lamp support, lamp protection, switch.

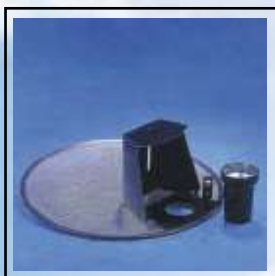

- Light kit for aluminum hood Ø 200 mm complete with: lampe halogene 24V. 20W., lamp support, lamp protection, sparks stop net, switch.

Hoods



STANDARD

- Aluminum hood for Ø 100/180/200 mm



- Aluminum hood for Ø200 mm complete with light Kit 24 V. 20W (**OPTIONAL**)



STANDARD

- Plastic hood for Ø 150 mm



- Supplied joint Ø150 mm

- Triaxe joint for Ø150 mm (**OPTIONAL**)



- Stainless steel hood (**OPTIONAL**)



STANDARD

- Enamelled metal hood Ø125 mm (only on request Ø150 mm)

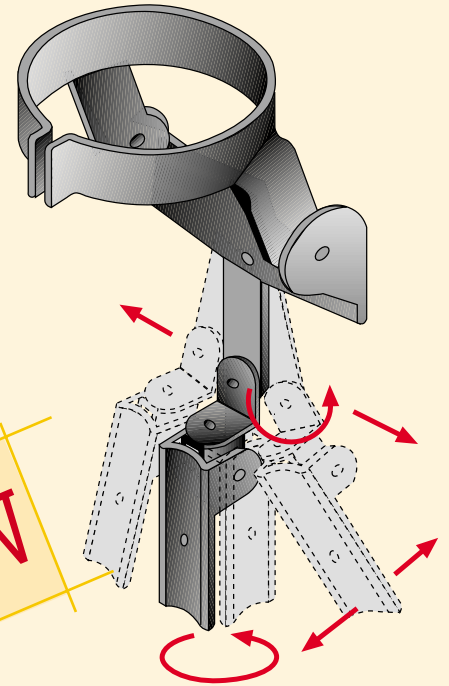

NEW

• Supplied joint Ø150 mm

• TRIAXE joint for hood Ø150 mm (optional)

The new TRIAXE joint allows a greater mobility of the hood.



* On request

Optionals



- Wall support for 1 pc fan

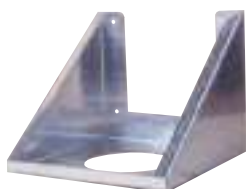

- Wall support for 1 pc Evolution arm



- NO SMOKE fans without rotary bearing



- “RAC” connection smooth outlet for NO SMOKE fans



- Various ductings

- Column support for 1 or 2 NO SMOKE fans
- Roof mounting support for 1 Evolution No-Smoke arm
- Column support for 1 or 2 Evolution No-Smoke arms
- Set of pipes for air outlet for arm and fan composed by:
1 pc. square to round connection, 1 90° bend, 1 straight pipe L=1000 mm, 2 collars.
- Control board
- Extension Bandiera
- Sliding duct Blindair